



# SX Super Chuck accessories

## SX coolant Assembly Tool



Series	Code No.
SX06	SXR-06
SX10	SXR-10
SX16	SXR-16
SX25	SXR-25

Tool is required for assembly and removal of SX collets from nuts.

## Coolant thru Adjust Screw

Holder	Code No.	Threads
SX06	ASC-8-24	M 8 x 1.25
SX10	ASC-12-30	M12 x 1.75
SX16	ASC-18-33	M18 x 1.5
SX25	ASC-25-30	M25 x 2.0
SX25	ASC-28-25	M28 x 2.0

## SXC coolant Nuts and Caps

Front threaded seal for air, coolant or keeping chips & swarf from entering the front of the collet.

Features:

- O-ring seal for pressure up to 10.3 MPa
- Prevent chips, dust & swarf from entering holders
- Jet Blast for non-coolant tools available upon request



SXCN coolant nut w/ SXC coolant cap

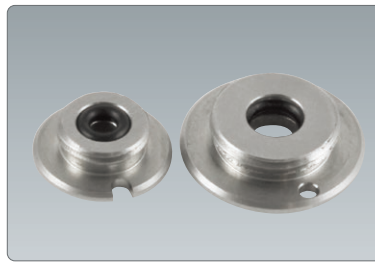

SXC coolant caps

## How to assemble

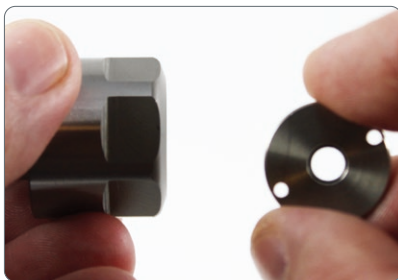

1. Thread coolant cap into SXCN nut, tighten with wrench after the collet has been assembled.

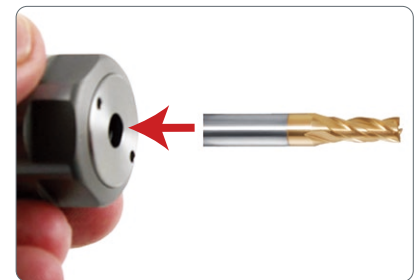

2. Insert a cutting tool.  
Shank of the cutting tool is engaged with O-ring.

## SXC coolant Nuts

Code No.	description	Thread	Wrench Type	Nut Wrench	Coolant Cap wrench
SXCN-06	SX06 Coolant Cap Nut	M15.5 X 1.0	Hex	SXW-06	SXW-CC
SXCN-10	SX10 Coolant Cap Nut	M21.5 X 1.0	Hex	SXW-10	
SXCN-16	SX16 Coolant Cap Nut	M32 X 1.5	Spanner	SXW-16	
SXCN-25	SX25 Coolant Cap Nut	M45 X 1.5	Spanner	SXW-25	



# SX Super chuck accessories

## ✚ SXC coolant caps

ΦD	SX06	SX10	SX16	SX25
2.0	SXC06-M020	SXC10-M020		
2.5	SXC06-M025	SXC10-M025		
3.0	SXC06-M030	SXC10-M030	SXC16-M030	
3.5	SXC06-M035	SXC10-M035	SXC16-M035	
4.0	SXC06-M040	SXC10-M040	SXC16-M040	
4.5	SXC06-M045	SXC10-M045	SXC16-M045	
5.0	SXC06-M050	SXC10-M050	SXC16-M050	
5.5	SXC06-M055	SXC10-M055	SXC16-M055	
6.0	SXC06-M060	SXC10-M060	SXC16-M060	
6.5		SXC10-M065	SXC16-M065	
7.0		SXC10-M070	SXC16-M070	
7.5		SXC10-M075	SXC16-M075	
8.0		SXC10-M080	SXC16-M080	
8.5		SXC10-M085	SXC16-M085	
9.0		SXC10-M090	SXC16-M090	
9.5		SXC10-M095	SXC16-M095	
10.0		SXC10-M100	SXC16-M100	
10.5			SXC16-M105	
11.0			SXC16-M110	
11.5			SXC16-M115	
12.0			SXC16-M120	
12.5			SXC16-M125	
13.0			SXC16-M130	
13.5			SXC16-M135	
14.0			SXC16-M140	
14.5			SXC16-M145	
15.0			SXC16-M150	
15.5			SXC16-M155	
16.0			SXC16-M160	SXC25-M160
16.5				SXC25-M165
17.0				SXC25-M170
17.5				SXC25-M175
18.0				SXC25-M180
18.5				SXC25-M185
19.0				SXC25-M190
19.5				SXC25-M195
20.0				SXC25-M200
20.5				SXC25-M205
21.0				SXC25-M210
21.5				SXC25-M215
22.0				SXC25-M220
22.5				SXC25-M225
23.0				SXC25-M230
23.5				SXC25-M235
24.0				SXC25-M240
24.5				SXC25-M245
25.0				SXC25-M250

\*Above chart refers to SXC coolant caps featured in the previous page.