

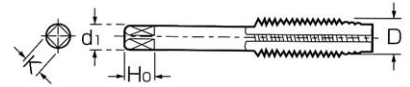

Tap Adapters without Overload clutch

RA

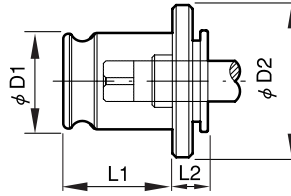

	Tapping Capacity	D1	D2	L1	L2
RA1	M03~M12	19.0	30.0	21.5	7.0
RA2	M08~M20	31.0	48.0	35.0	11.0
RA3	M14~M33	48.0	70.0	55.5	14.0

Tap (JIS standard)				shk dia	□dia	length	Tap Adapters		
D				d1	K	Ho	Series #1	Series #2	Series #3
M3	M3.5	No.5	No.6	4.0	3.2	6.0	RA1J-M03		
M4	M4.5	No.8		5.0	4.0	7.0	RA1J-M04		
M5		No.10	No.12	5.5	4.5	7.0	RA1J-M05		
M6		No.14	U1/4	6.0	4.5	7.0	RA1J-M06		
M8	M7			6.2	5.0	8.0	RA1J-M08	RA2J-M08	
M10	M9	U3/8		7.0	5.5	8.0	RA1J-M10	RA2J-M10	
M11		U7/16	P1/8	8.0	6.0	9.0	RA1J-M11	RA2J-M11	
M12				8.5	6.5	9.0	RA1J-M12	RA2J-M12	
M14	M15	U9/16		10.5	8.0	11.0		RA2J-M14	RA3J-M14
M16				12.5	10.0	13.0		RA2J-M16	RA3J-M16
M18		U3/4	P3/8	14.0	11.0	14.0		RA2J-M18	RA3J-M18
M20				15.0	12.0	15.0		RA2J-M20	RA3J-M20
M22		U7/8		17.0	13.0	16.0		RA2J-M22	RA3J-M22
M24	M25		P5/8	19.0	15.0	18.0		RA2J-M24	RA3J-M24
M27	M26	U1"		20.0	15.0	18.0			RA3J-M27
M30			P3/4	23.0	17.0	20.0			RA3J-M30
M33				25.0	19.0	22.0			RA3J-M33
M36	M38		P1.1/8	28.0	21.0	24.0			RA3J-M36

Tap (DIN standard)				shk dia	□dia	length	Tap Adapters		
D				d1	K	Ho	Series #1	Series #2	Series #3
M3(371)	M5(376)			3.5	2.7	6.0	RA1D-M03(371)		
M4(371)	M6(376)			4.5	3.4	6.0	RA1D-M04(371)		
M5(371)	M6(371)	M8(376)		6.0	4.9	8.0	RA1D-M05(371)	RA2D-M08(376)	
M8(371)				8.0	6.2	9.0	RA1D-M08(371)	RA2D-M08(371)	
M10(371)				10.0	8.0	11.0	RA1D-M10(371)	RA2D-M10(371)	
M10(376)	P1/8			7.0	5.5	8.0	RA1D-M10(376)	RA2D-M10(376)	
M12(376)				9.0	7.0	10.0	RA1D-M12(376)	RA2D-M12(376)	
M14(376)	P1/4			11.0	9.0	12.0		RA2D-M14(376)	RA3D-M14(376)
M16(376)	P3/8			12.0	9.0	12.0		RA2D-M16(376)	RA3D-M16(376)
M18(376)				14.0	11.0	14.0		RA2D-M18(376)	RA3D-M18(376)
M20(376)	P1/2			16.0	12.0	15.0		RA2D-M20(376)	RA3D-M20(376)
M22(376)	M24(376)	P5/8		18.0	14.5	17.0		RA2D-M22(376)	RA3D-M22(376)
M27(376)	P3/4			20.0	16.0	19.0			RA3D-M27(376)
M30(376)	P7/8			22.0	18.0	21.0			RA3D-M30(376)
M33(376)	P1"			25.0	20.0	23.0			RA3D-M33(376)
M36(376)	P1.1/8			28.0	22.0	25.0			RA3D-M36(376)

Tap (ISO standard)				shk dia	□dia	length	Tap Adapters		
D				d1	K	Ho	Series #1	Series #2	Series #3
M3	No.4	No.5		3.15	2.5	5.0	RA1S-M03		
M4				4.0	3.15	6.0	RA1S-M04		
M5	No.10			5.0	4.0	7.0	RA1S-M05		
M6	U1/4			6.3	5.0	8.0	RA1S-M06		
M8	U5/16	P1/8		8.0	6.3	9.0	RA1S-M08	RA2S-M08	
M10	U3/8	P1/4		10.0	8.0	11.0	RA1S-M10	RA2S-M10	
M12	U1/2			9.0	7.1	10.0	RA1S-M12	RA2S-M12	
M14				11.2	9.0	12.0		RA2S-M14	RA3S-M14
M16	U5/8	P3/8		12.5	10.0	13.0		RA2S-M16	RA3S-M16
M18	M20	U3/4		14.0	11.2	14.0		RA2S-M18	RA3S-M18
M22	U7/8	P1/2		16.0	12.5	16.0		RA2S-M22	RA3S-M22
M24	U1"	P5/8		18.0	14.0	18.0		RA2S-M24	RA3S-M24
M27	M30	U1.1/8	P3/4	20.0	16.0	20.0			RA3S-M27
M33	U1.1/4	P7/8		22.4	18.0	22.0			RA3S-M33
M36	U1.3/8	P1"		25.0	20.0	24.0			RA3S-M36